

Phone: +370 706 94 613 SE "ORO NAVIGACIJA"  
 Fax: +370 706 94 614 Aeronautical Information Service  
 AFS: EYVNYOYX Rodūnios kelias 2  
 URL: <http://www.ans.lt> LT-02188 Vilnius, Lithuania  
 Email: [ais@ans.lt](mailto:ais@ans.lt)

**AIP SUP: 06/2019**  
**Effective from: 09-Sep-2019**  
**to: 09-Nov-2019**  
**Publication Date: 28-Aug-2019**

## S 06. RECONSTRUCTION OF TAXIWAY E IN SIAULIAI AERODROME

Reconstruction of taxiway (TWY) E ECHO adjacent to the main runway RWY 14L/32R in Siauliai aerodrome (EYSA) will take place **from 9 September 2019 to 9 November 2019**.

Due to TWY E (ECHO) reconstruction works:

- adjacent to end of RWY THR 32R /RWY 14L, by 470 metres temporarily displaced THR 32R together with 14L end,
- displaced threshold is marked,
- RWY 32R landing and fixed distance marks relocated,
- RWY 14L/32R characteristics and published distances changed.

RWY Designator	TORA (M)	TODA (M)	ASDA (M)	LDA (M)
14L	3030	3030	3030	3030
From TWY B, H	2180	2180	2180	2180
32R	3030	3030	3030	3030
From TWY I	2950	2950	2950	2950

During the reconstruction the following restrictions apply:

1. RWY 32R – daytime VFR flights.
2. ILS RWY 32R not working.
3. PAPI RWY 32R lights not working.
4. APCH lights RWY 32R not working.
5. THR lights RWY 32R not working.
6. CL lights RWY 14L/32R not working.
7. EDGE lights within the range of 600 M up to RWY 14L end emitting yellow light.
8. From displaced RWY 14L end within the range of 3 M, in the line perpendicular to RWY centreline, six (6) elevated RWY END lights will be erected emitting red light towards the RWY.
9. TWY J within the range from RWY 14L/32R to parking stand No. 8 closed.
10. Work in progress area established 170 M from TWY E (ECHO) edge.

Appendix. Temporary chart of aerodrome.

-END-

THIS PAGE INTENTIONALLY LEFT BLANK

---

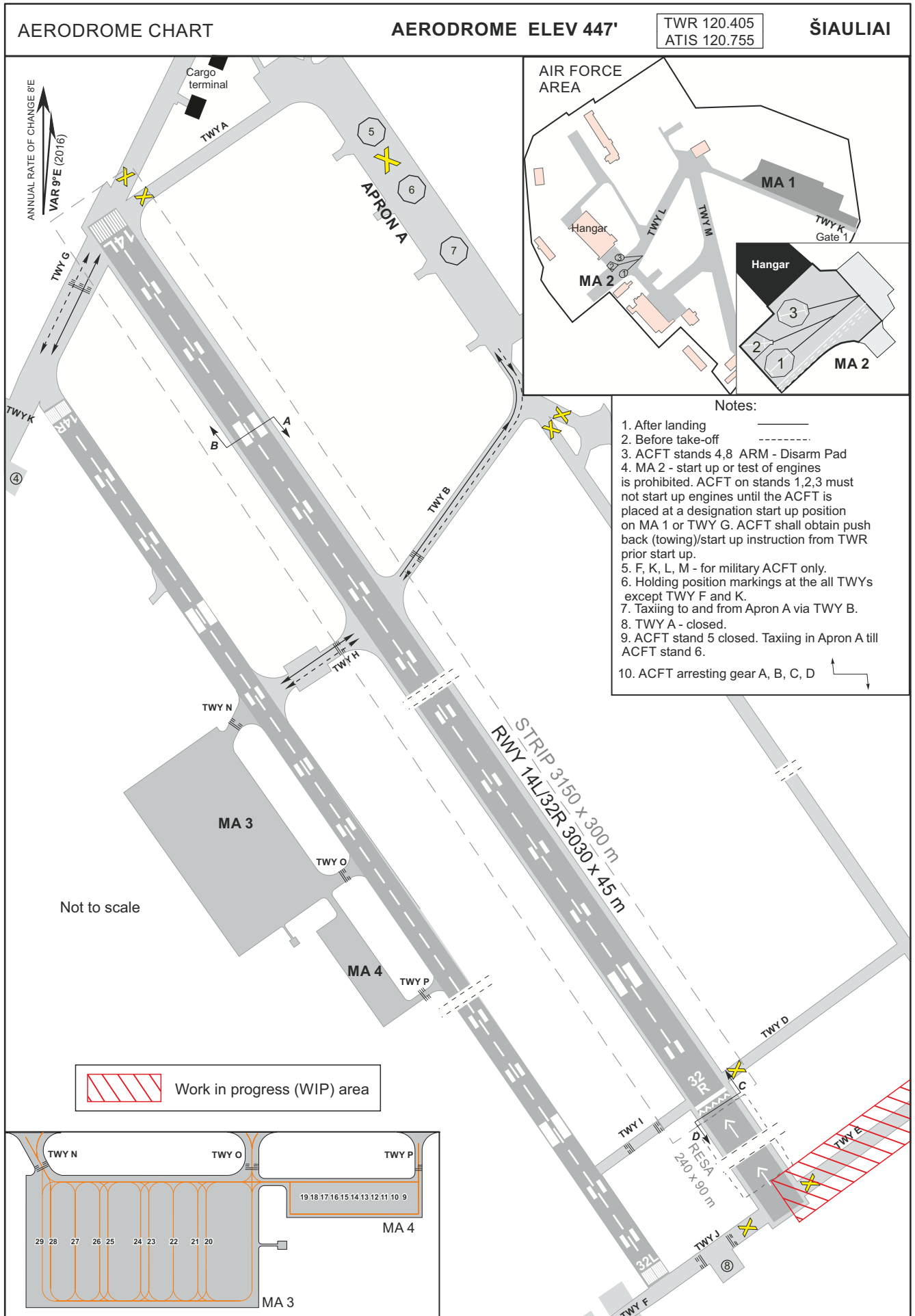

THIS PAGE INTENTIONALLY LEFT BLANK

---